

Main applications

Pharmaceutical

Characteristics

- Designed in accordance with EN 13445 code.
- Materials in contact with fluids: 316L-SS.
- Mechanically polished surfaces.
- Available in single and multiple (3, 5) cartridges version:
 - 1 cartridge: standard V-Clamp or Heavy Duty V-Clamp
 - 3 & 5 cartridges: Rathmann clamp.
- Suitable for cod.7 cartridges, height from 5" to 40".
- In-line connections with inlet condensation chamber.
- Suitable for SIP (in site sterilization).
- Compliant with 2014/68/UE PED Directive.
- Compliant with 2014/34/UE ATEX Directive.
- Compliant with 1935/2004/UE Directive.
- Suitable for liquids and gases Gr.2.
- Standard base/bowl sealing with Silicone O-ring.
- 100% hydraulically tested filters.



CHARACTERISTICS	
Base / Bowl	316L-SS
V-clamp	304-SS
Internals	316L-SS
Not wet external parts	304-SS
Gaskets	Silicone O-ring
Internal surface finishing	Inlet side: mechanical polishing Ra < 0.8 µm (32 µin) Outlet side (downstream cartridge): mechanical polishing Ra < 0.4 µm (16 µin)
External surface finishing	Mechanical polishing
Design pressure	-1 ÷ 10 bar (V-Clamp) or -1 ÷ 16 bar (Heavy Duty V-Clamp) -1 ÷ 10 bar (Rathmann clamp)
Design temperature	-20 ÷ 150 °C
ATEX classification	II 2 G Ex h IIC T3 Gb / II 2 D Ex h IIC 150°C Db

Dimensions

Model	Tipo	Cartridge qty	Dimensions [mm]								
			A	B	C	D _{5"}	D _{10"}	D _{20"}	D _{30"}	D _{40"}	In/out
GPCPV01 (1)SA01C-R048	1	1	88.9	139	99	381	501	751	1001	1251	1" TC ASME BPE
GPCPV01 (1)SA1HC-R048	1	1	88.9	1398	99	381	501	751	1001	1251	1.1/2" TC ASME BPE
GPCPV01 (1)SA02C-R048	1	1	88.9	148	95	381	501	751	1001	1251	2" TC ASME BPE
GPCPV03 (1)SA03C-R048	2	3	219.1	320	189		757	1007	1257	1507	DN 80 DIN 32676-B
GPCPV05 (1)SA04C-R048	2	5	273	375	223		841	1091	1341	1591	DN 100 DIN 32676-B

Manufacturing tolerances: contact Asco Filtri.

(1) Cartridge length.

Single cartridge filter: vent 1.1/2" TC ASME BPE - drain 1/2" TC ASME BPE.

3 & 5 cartridges filter: vent and drain 1.1/2" TC ASME BPE.

Model	Nr x H	Volume [lt]	Cat. PED	Weight [kg]
GPCPV01H	1 x 5"	2.2	4.3	2.6
GPCPV011	1 x 10"	3.0	4.3	3.0
GPCPV012	1 x 20"	4.0	4.3	4.0
GPCPV013	1 x 30"	6.0	I	5.0
GPCPV014	1 x 40"	7.0	I	6.0

Model	Nr x H	Volume [lt]	Cat. PED	Weight [kg]
GPCPH01H	1 x 5"	2.2	4.3	2.6
GPCPH011	1 x 10"	3.0	4.3	3.0
GPCPH012	1 x 20"	4.0	I	4.0
GPCPH013	1 x 30"	6.0	I	5.0
GPCPH014	1 x 40"	7.0	I	6.0

Model	Nr x H	Volume [lt]	Cat. PED	Weight [kg]
GPCPM031	3 x 10"	28	II	31
GPCPM032	3 x 20"	37	II	34
GPCPM033	3 x 30"	46	II	37
GPCPM034	3 x 40"	55	II	40

Model	Nr x H	Volume [lt]	Cat. PED	Weight [kg]
GPCPM051	5 x 10"	45	II	34
GPCPM052	5 x 20"	59	II	38
GPCPM053	5 x 30"	73	II	42
GPCPM054	5 x 40"	87	II	46

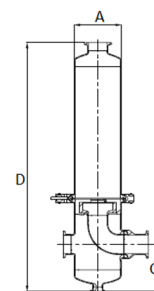

Type 1

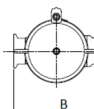
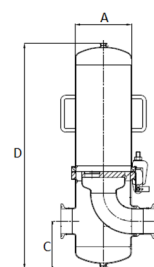

Type 2

Optional accessories

Diaphragm pressure gauge with sanitary valve and 1.1/2" TC clamp.

Vent and drain ball valve with hosebarb and 1.1/2" TC clamp.

1.1/2" TC ASME BPE vent with lateral sampling port.

Sampling port with hosebarb and ASME BPE TC clamp.

Sampling port with STAUBLI RBE 03 and ASME BPE TC clamp.

Sampling port with RECTUS 21 and ASME BPE TC clamp.

304-SS Removable legs (only for 3 & 5 cartridges filter).

Contact us for any further information.

We reserve the right to change the data of this specification without notice.